

PREPARED FOR:
SCOTT LENNERS

PLAT OF SURVEY

J.K. SURVEYING INC.
N3705 WILLOWBEND LANE
LAKE GENEVA, WI, 53147
262-248-3697

-OF-

LOTS 172-177, BLOCK 3, PELL LAKE SUBDIVISION,
A SUBDIVISION LOCATED IN SECTION 22, TOWN 1 NORTH,
RANGE 18 EAST, TOWN OF BLOOMFIELD, WAL WORTH
COUNTY, WISCONSIN

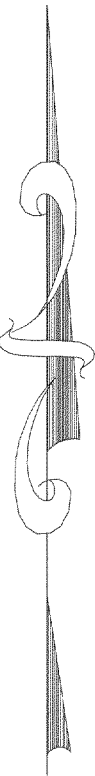

MAR 3
KW

- () = recorded as
- = found iron bar
- = found iron pipe
- = set iron pipe
- = set iron bar

COMPARE LEGAL DESCRIPTION ABOVE AND DRAWING WITH DEED. FOR BUILDING RESTRICTIONS AND EASEMENTS NOT SHOWN, REFER TO DEED, ABSTRACT SOURCES AND LOCAL MUNICIPAL CODES. NOTIFY THE SURVEYOR IMMEDIATELY OF ANY DISCREPANCY.

"I hereby certify that the above described property was surveyed under my supervision and that the above map, to the best of my knowledge and belief, is a true representation thereof and shows the size and location of all visible structures, apparent easements and encroachments if any."
This survey is made for the present owners of the property, and those who purchase, mortgage, or guarantee the title thereto, within one year from the date hereof.

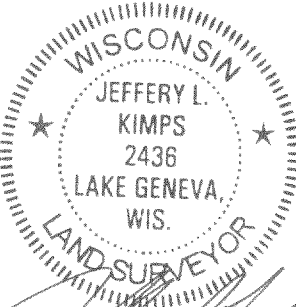

JEFFREY L KIMPS S - 2436
Wisconsin Registered Land Surveyor
(original if signed in red)

REVISED JANUARY 8th, 2004 (PROPOSED HOUSE)
DATED THE 24 TH, DAY OF NOVEMBER 2003

SCALE 1" = 20'

JOB # 03-728ph

TAX ID # MPL 00040

118-2408